

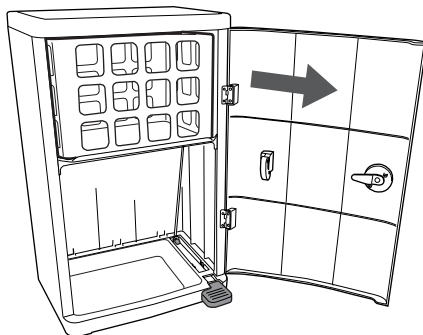

JANIBELL REFILL INSTALLATION INSTRUCTION

1

Open front door and pull out empty refill cartridge.



2

Slide new refill over empty refill cartridge.

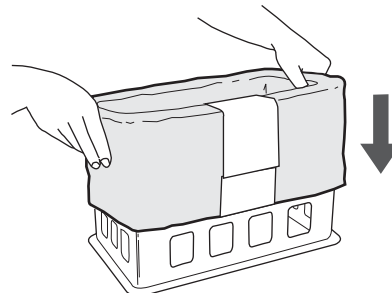

3

Remove the paper band and pull up OUTER LAYER of the refill.

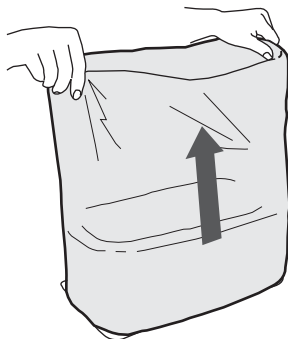

4

Push refill down through the middle of the cartridge.

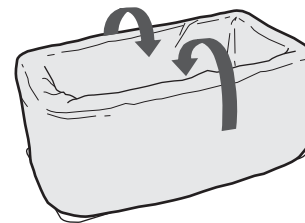

5

Insert the cartridge, with the newly installed refill back into the can.

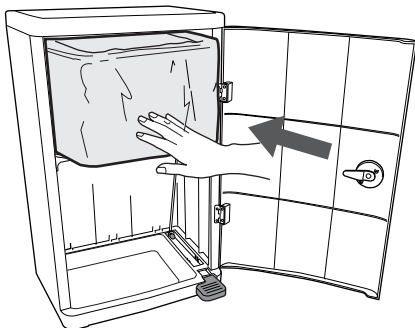

6

Pull refill down and tie a knot.

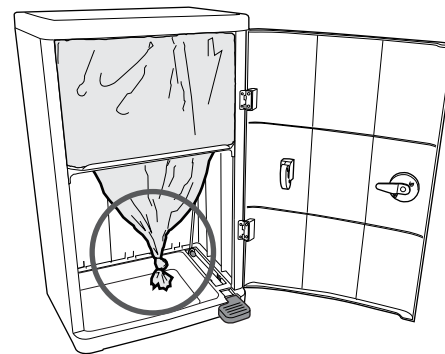

For further assistance please visit www.janibell.com, or, call our Customer Service Department at 1-800-856-0332 Monday through Friday, 7:00 am ~ 3:30 pm PST.